

**TRANSMITTAL SHEET**

This sheet transmits Revision 5 to Service Bulletin SB34-15.

- A. Revises effectivity to exclude airplanes -0001 thru -0349 incorporating SB57-12.
- B. Makes other minor changes and corrections as indicated.

NOTE: This revision replaces the original issue and previous revisions of SB34-15 in their entirety.

Airplanes previously modified by this service bulletin are not affected by this revision.

SUMMARY OF REVISIONS:

Original Issue	Jun 11/73
Revision 3	Apr 28/77
Revision 4	Aug 19/80
Revision 5	Jul 12/89

# **SERVICE BULLETIN REVISION**

## **TRANSMITTAL SHEET**

This sheet transmits Revision 4 to Service Bulletin SB34-15.

- a. Revise to show use of the new 9912076-4, 9912076-5 and 9912076-9 Airspeed/Mach Warning Switches for the applicable airplanes.
- b. Change the effectivity to Unit -0001 and On.
- c. Rearrange the text and material information list to clarify areas for those airplanes requiring specific instructions and parts.
- d. Revise Figure 1 illustration to show applicable to airplane units -0001 thru -0349.
- e. Added Figure 2 illustration for airplane units -0350 and On.

NOTE: This revision replaces Service Bulletin SB34-15 in its entirety.

Airplanes previously modified by this Service Bulletin are not affected by this revision.

# **SERVICE BULLETIN REVISION**

## **TRANSMITTAL SHEET**

This page transmits Revision 3 to Service Bulletin 34-15.

- a. Bulletin text and parts list revised to make bulletin applicable to Model 501 aircraft 501-0001 and On.

NOTE: Aircraft previously modified by SB34-15 are not affected by this revision.

TITLE NAVIGATION - 9500 POUND ZERO FUEL WEIGHT INSTALLATION

EFFECTIVITY

<u>MODEL</u>	<u>UNIT NUMBER</u>
500/501	-0001 Thru -0349 not incorporating SB57-12, and -0350 Thru -0689

REASON

To allow a zero fuel weight of 9500 pounds.

DESCRIPTION

This modification replaces the mach/airspeed indicator, mach/airspeed switch and with like items that indicate a new maximum operating limit speed. For Model 500 certified airplanes only, replace the operational limitation placard with a placard that indicates the newer operating limitations.

COMPLIANCE

Optional at operators request.

APPROVAL

FAA approval has been obtained on technical data in this publication that affects airplane type design.

Revision 5 - Jul 12/89

34-15  
Page 1 of 9  
Jun 11/73

MANPOWER

<u>Work Phase</u>	<u>Man-Hours</u>
Installation	*

MATERIAL - Cost and Availability

<u>Part Number</u>	<u>Availability</u>	<u>Cost</u>
SB34-15-0	*	*
SB34-15-1	*	*
SB34-15-2	*	*
SB34-15-3	*	*
SB34-15-4	*	*
SB34-15-5	*	*

\*Refer to the attached Service Bulletin Supplemental Data sheet for man-hours, material cost and availability information.

TOOLING

None.

WEIGHT AND BALANCE

None.

REFERENCE

This service bulletin may not be installed on airplanes -0001 thru -0349 incorporating SB57-12, Wings - Airplane Configuration Update.

OTHER PUBLICATIONS AFFECTED

Cessna Model 500 Citation/Citation I FAA Approved Airplane Flight Manual  
 Cessna Model 501 Citation I/SP FAA Approved Airplane Flight Manual

ACCOMPLISHMENT INSTRUCTIONS

NOTE: Before beginning work, ensure that all electrical switches are off and that there is no external or battery power connected to the airplane. Attach a maintenance tag to battery switch warning maintenance and service personnel of electrical condition of the airplane.

1. (Refer to Figure 1.) Disconnect the electrical connectors, the pitot lines, the static lines and remove both the pilot's and copilot's airspeed indicators. Retain the clamps and screws for reinstallation.

NOTE: Access for removal of the airspeed indicators can be obtained by removing the respective flight panel; however, in most cases an adjacent "slide out" type indicator or instrument such as a Flight Director Indicator or a Horizontal Situation Indicator can be removed easily and access to the airspeed indicator can be obtained through the resulting opening.

NOTE: Cap all pitot and static system lines as they are disconnected to prevent the entry of foreign objects.

2. Remove both the existing mach/airspeed indicators. (Refer to the Maintenance Manual, Chapter 34, Mach/Airspeed Indicators - Removal/Installation.)
  - A. (Refer to Figure 1, Sheet 1, Detail A.) Airplanes -0001 thru -0349, remove the C661062-0101 or C661063-0101 Mach/Airspeed Indicators left and right. Retain removed hardware. Discard packings.
  - B. (Refer to Figure 1, Sheet 2, Detail B.) Airplanes -0350 thru -0689, remove the C661063-0102 Mach/Airspeed Indicators left and right. Retain removed hardware. Discard packings.
3. Install new mach/airspeed indicators. (Refer to the Maintenance Manual, Chapter 34, Mach/Airspeed Indicators - Removal/Installation.)
  - A. (Refer to Figure 1, Sheet 1, Detail A.) Airplanes -0001 thru -0349, install C661063-0102 Mach/Airspeed Indicators in place of removed C661062-0101 or C661063-0101 indicators, using existing hardware and new packings furnished in this bulletin.
  - B. (Refer to Figure 1, Sheet 2, Detail B.) Airplanes -0350 thru -0689, install C661063-0103 Mach/Airspeed Indicators in place of removed C661063-0102 indicators, using existing hardware and new packings furnished in this bulletin.
4. Remove the pilot's seat. (Refer to the Maintenance Manual, Chapter 25, Flight Crew Seats - Maintenance Practices.)

5. Locate the Mach/Airspeed Warning Switch attached to the aft side of the forward cabin pressure bulkhead directly forward of the pilot's flight panel. Disconnect the pitot and static system lines and the electrical connector. Remove and retain the attaching screws and remove and discard the Mach/Airspeed Warning Switch. Discard the O-ring packings from the pitot and static system connections.
6. Install the new airspeed/mach warning switch outlined below. (Refer to the Maintenance Manual, Chapter 34, Overspeed Warning - Maintenance Practices.)
  - A. Airplanes -0001 thru -0349, use 9912076-4 (alternate 9912076-8) Airspeed/Mach Warning Switch.
  - B. Airplanes -0350 thru -0483, use 9912076-5 Airspeed/Mach Warning Switch.
  - C. Airplanes -0484 thru -0689, use 9912076-9 Airspeed/Mach Warning Switch.

NOTE: When replacing the airspeed/mach warning switch on airplanes -0001 thru -0483, also replace the 5514190-10 and 5514190-23 Line Assemblies with 5514190-70 and -71 Line Assemblies, respectively.

7. (Model 500 Airplanes Only.) Remove placard from left pilots console.
  - A. Remove placard from left pilot's console by removing screws, nuts and shield. Retain shield, screws and nuts for reinstallation.
8. (Model 500 Airplanes Only.) Install new placard on left pilot's console.
  - A. (Airplanes -0001 thru -0349.) Install 5500125-13 Placard in place of removed placard using screws, nuts and shield retained at removal.
  - B. (Airplanes -0350 thru -0689.) Install 5500126-7 Placard in place of removed placard using screws, nuts and shield retained at removal.
9. Perform a pitot-static leak check of the pilot and copilot system. (Refer to the Maintenance Manual, Chapter 34, Flight Environment Data - Maintenance Practices.)
10. Perform a functional check of the overspeed warning system. (Refer to the Maintenance Manual, Chapter 34, Overspeed Warning - Maintenance Practices.)

11. Update the FAA Approved Airplane Flight Manual as follows:
  - A. (Model 500 Airplane.) Ensure that Supplement 7 (latest revision) is incorporated in the FAA Approved Airplane Flight Manual.
  - B. (Model 501 Airplane.) Ensure that Supplement 1 (latest revision) is incorporated in the FAA Approved Airplane Flight Manual.
12. Make an entry in the Airplane Logbook stating this Service Bulletin has been complied with. Fill out and forward a Maintenance Transaction Report indicating compliance to: CESCO, P.O. Box 7706, Wichita, KS 67277.



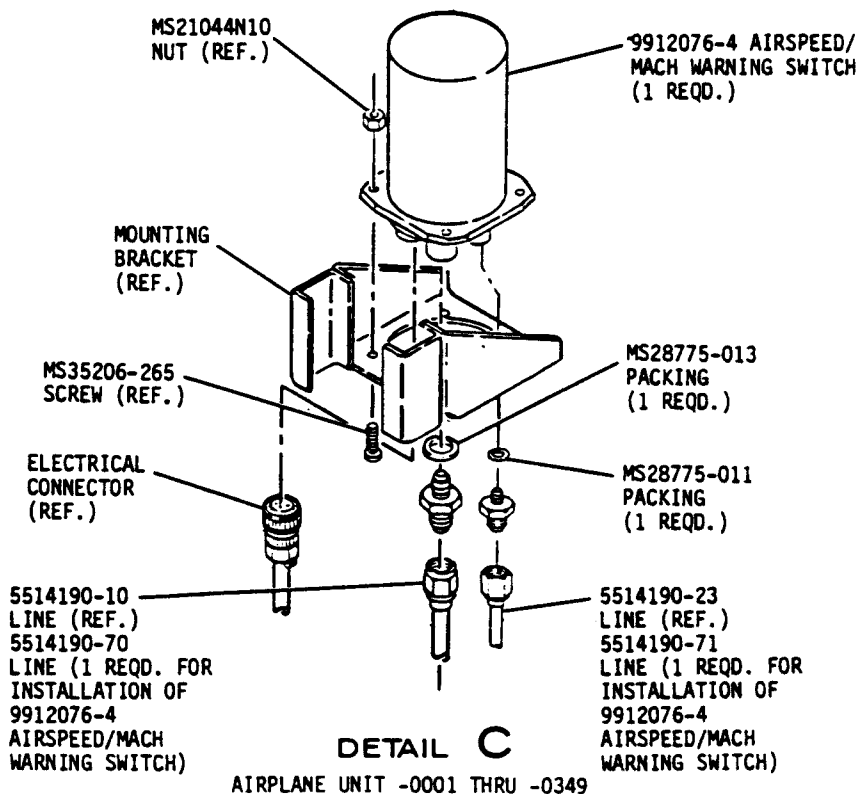
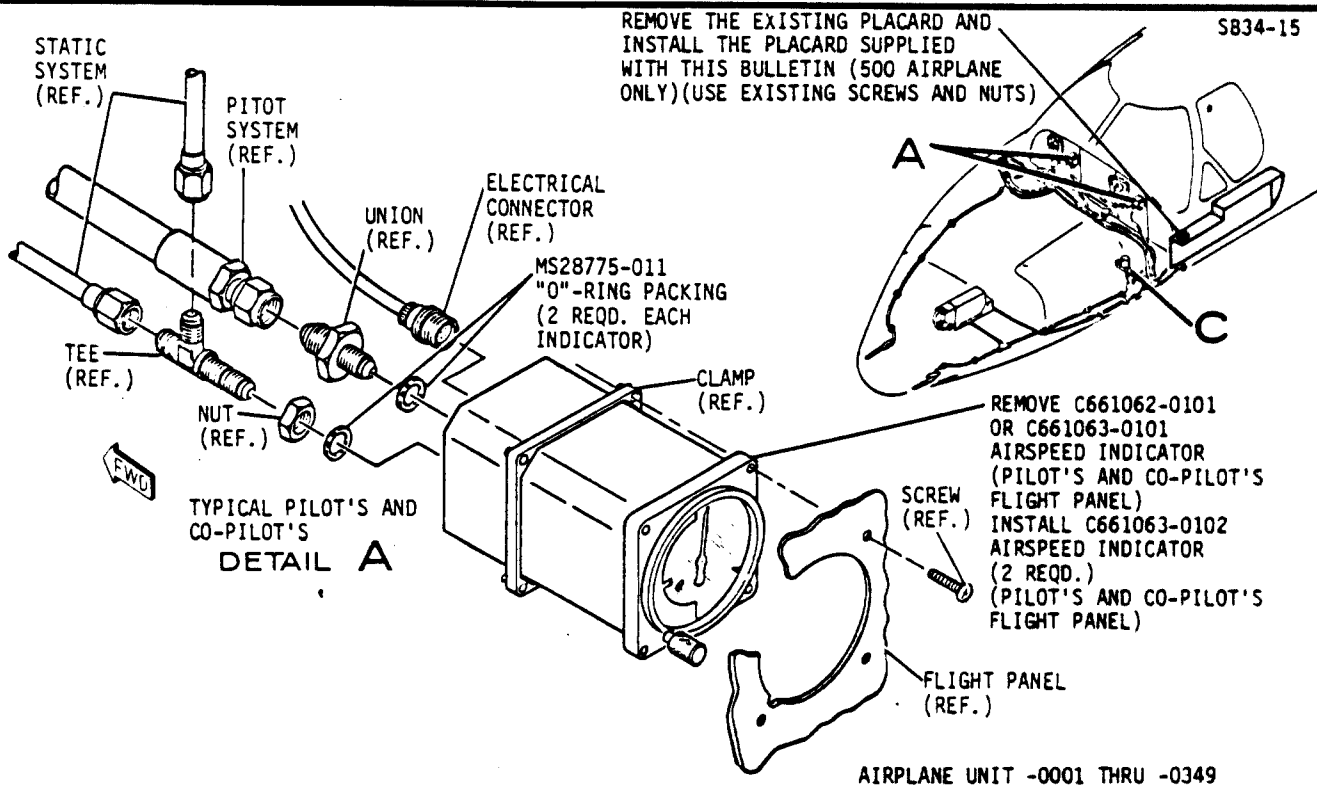

Figure 1. 9500 Pound Zero Fuel Weight Option Installation (Sheet 1 of 2)

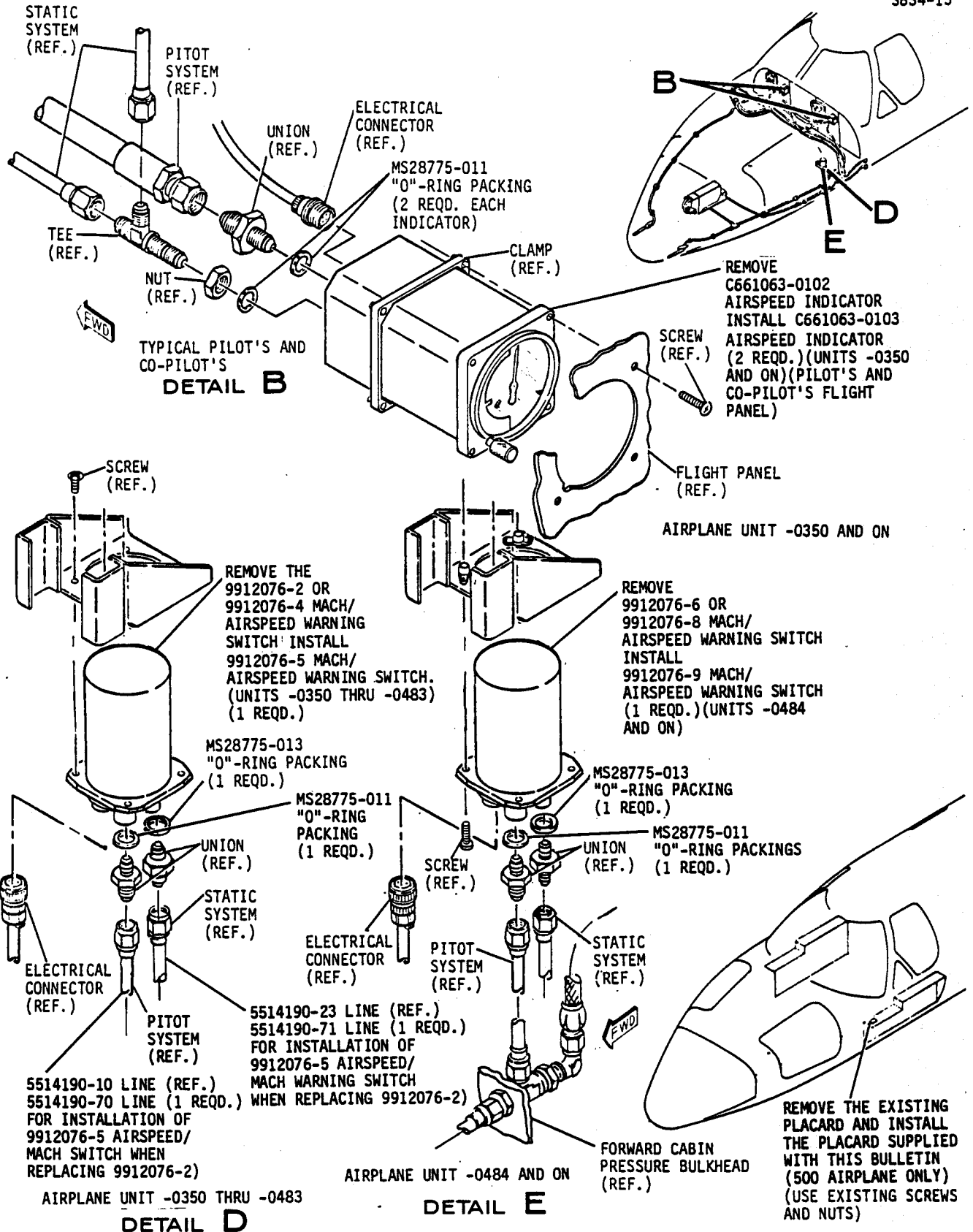

Figure 1. 9500 Pound Zero Fuel Weight Option Installation (Sheet 2)

MATERIAL INFORMATION

The parts included in this bulletin cover installation for one airplane.

<u>NEW P/N</u>	<u>QUANTITY</u>	<u>KEY WORD</u>	<u>OLD P/N</u>	<u>INSTRUCTIONS/ DISPOSITION</u>
SB34-15-0	1	Required for all Model 500 and 501 Airplanes consisting of the following parts.		
MS28775-011	5	Packing		
MS28775-013	1	Packing		

For airplanes -0001 thru -0349, order the following kit in addition to SB34-15-0:

SB34-15-1	1	Required, consisting of the following parts:		
C661063-0102	2	Mach/Airspeed Indicator	C661062-0101 or C661063-0101	
9912076-4 (Alternate 9912076-8)	1	Airspeed/Mach Warning Switch	9912076-1	
5500125-13	1	Placard	5501001-45	

For airplanes -0350 thru -0483, order the following kit in addition to SB34-15-0:

SB34-15-2	1	Required, consisting of the following parts:		
9912076-5	1	Airspeed/Mach Warning Switch	9912076-2 or 9912076-4	

For airplanes -0484 thru -0689, order the following kit in addition to SB34-15-0:

SB34-15-3	1	Required, consisting of the following parts:		
9912076-9	1	Airspeed/Mach Warning Switch	9912076-6 or 9912076-8	

For airplanes -0001 thru -0483, order the following kit in addition to SB34-15-0 and SB34-15-1 or -2:

SB34-15-4	1	Required, consisting of the following parts:		
5514190-70	1	Line Assembly	5514190-10	
5514190-71	1	Line Assembly	5514190-23	

MATERIAL INFORMATION (Continued):

<u>NEW P/N</u>	<u>QUANTITY</u>	<u>KEY WORD</u>	<u>OLD P/N</u>	<u>INSTRUCTIONS/ DISPOSITION</u>
For airplane -0350 thru -0689, order the following kit in addition to SB34-15-0 and SB34-15-2 or -3:				
SB34-15-5	1	Required, consisting of the following part:		
C661063-0103	2	Mach/Airspeed Indicator	C661063-0102	
5500126-7	1	Placard	5500125-4	

SB34-15

TITLE

NAVIGATION - 9500 POUND ZERO FUEL WEIGHT INSTALLATION

EFFECTIVITY

<u>MODEL</u>	<u>UNIT NUMBERS</u>
500/501	-0001 Thru -0349 not incorporating SB57-12, and -0350 Thru -0689

MANPOWER

<u>Work Phase</u>	<u>Man-Hours</u>
Installation	Quoted on Request (Consult Citation Service Facility)

MATERIAL - Cost and Availability

<u>Part Number</u>	<u>Availability</u>	<u>Cost</u>
SB34-15-0	*	*
SB34-15-1	*	*
SB34-15-2	*	*
SB34-15-3	*	*
SB34-15-4	*	*
SB34-15-5	*	*

\*Please contact Citation Service Facility or Citation Parts Department, telephone number 316-946-6282, or telex 431-9023 for current cost and availability.

34-15  
Jul 12/89